



*India*

# WONDERS OF THE HIMALAYAS

PARO TO BAGDOGRA - 16 NIGHTS

Explore the mystical Eastern Himalayas on this new cruise and land tour with Pandaw. Discover the Kingdom of Bhutan including the famous cliff-top monasteries and the unique way of life that remains largely unchanged and un-influenced by the modern world. From Bhutan, travel to North Eastern India and Assam for a 7-night river expedition along the Brahmaputra River, including jeep safari at Kaziranga National Park. The newest Land & Cruise Tour from Pandaw is a true expeditionary adventure that is not to be missed.

**Note:** Medium fitness is required for a soft hike in Bhutan. The weather in Bhutan and Assam can be very cold during winter months. Please check the average temperatures for your departure date and pack accordingly.



[VIEW ONLINE](#)

# CONTENTS

---



Route Map .....	p.3
Itinerary .....	p.4
Pandaw Stateroom .....	p.8
Ships - RV Kindat Pandaw .....	p.9
Pre & Post Hotels .....	p.10
Other information .....	p.18

# ROUTE MAP

## PART 1

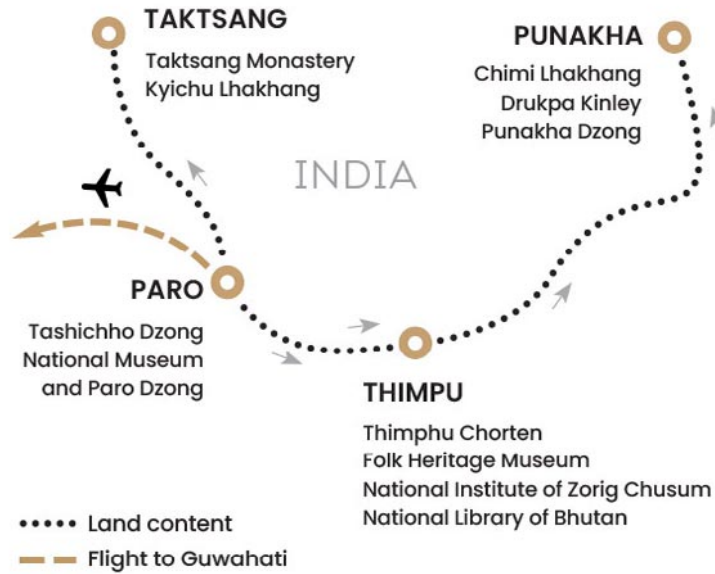

Not to scale

## PART 2





# ITINERARY

---



## DAY 1 ARRIVAL PARO

Welcome to Bhutan! Pick up at Paro international airport. After Lunch in the city, drive on a winding road to Thimphu (one hour), the capital of Bhutan.

Visit Tashichho Dzong, Bhutan's most impressive building. It has traditionally been the seat of the Druk desi or 'Dharma Raja', the head of Bhutan's civil government, an office which has been combined with the kingship since the creation of the monarchy in 1907. It houses the throne room of His Majesty the King of Bhutan and is the summer residence of the venerated monastic community. The current Dzong is the impressive result of a redesign of the original medieval structure sanctioned by the Third King, His Majesty King Jigme Dorji Wangchuck, when he moved the capital to Thimphu from Punakha.

**Meals:** lunch depending on arrival time.



## DAY 2 THIMPU

After breakfast visit the Memorial Chorten, also known as the Thimphu Chorten, a large Tibetan-style Buddhist Monastery with golden spires and bells. It was built in 1974 to honor the memory of the third King, Jigme Dorji Wangchuck.

Continue to the Folk Heritage Museum, National Institute of Zorig Chusum and the National Library of Bhutan, Junghi Paper Factory, National Institute of Traditional Medicine and Bhutan Postal Museum.

**Meals:** breakfast at hotel.



## DAY 3 THIMPU - PUNAKHA

After breakfast, we take the Dochula pass, located 30 km from the capital, on the way to Punakha which offers a 360-degree of beautiful panoramic view of the Himalaya mountain range. Visit Chimi Lhakhang, a monastery dedicated to Lama Drukpa Kinley or 'the Divine Madman'. An accomplished master of Mahamudra Buddhist Tradition, he is also known as the 'Mad Saint' for his unorthodox ways of teaching Buddhism by singing, humor and outrageous behavior.

Continue to Drukpa Kinley, also a cultural icon in Bhutan around whom countless yarns, fictions, stories and legends have been spun. In founding the site, it is said that Lama Kunley subdued a demon of Dochu La with his "magic thunderbolt of wisdom" and trapped it in a rock at the location close to where the chorten now stands.

**Meals:** breakfast at hotel and lunch box.



# ITINERARY

---



## DAY 4 PHUNAKA – PARO

After breakfast, visit the Punakha Dzong, also known as Pungtang Dechen Photrang Dzong (meaning ‘the palace of great happiness or bliss’), the administrative centre of Punakha dzongkhag. Constructed in 1673, it is the second oldest and second largest dzong in Bhutan and one of its most majestic structures.



Drive to Paro then and visit the National Museum and Paro Dzong. The National Museum of Bhutan is housed inside the revamped circular Ta-dzong building, an ancient watchtower above the Paro Dzong. This unusual round building is said to be in the shape of a conch shell. The original building was constructed in 1656 and then converted into a museum in 1968, housing some of the finest specimens of Bhutanese art, including masterpieces of bronze statues and paintings gathered from different parts of the country.

**Meals:** breakfast at hotel and dinner with local family.



## DAY 5 PARO TAKTSANG SOFT HIKE

Drive to Satsam Chorten for a soft hike to Taktsang Monastery. The name Taktsang means “Tiger’s Nest”. The monastery is perched on a rocky ledge with a sheer drop of nearly 800m, overlooking the Paro Valley and the river. It is said that in the second half of the 8th century, Guru Padma Sambhava known as the second Buddha in Bhutan, meditated at the spot where the monastery is situated having alighted there on the back of a flying tigress.

The hike takes about 4 hours back and forth. Once you reach the view point of the monastery you have the option to visit the monastery which takes another hour hike.

After visit a Farm House where your dinner will be arranged with the local family.

**Meals:** breakfast at hotel.



## DAY 6 PARO - GUWAHATI

After breakfast transfer Paro International Airport for your flight to Guwahati. Free time in the evening to relax.

**Meals:** breakfast at hotel.



# ITINERARY

---



## DAY 7 GUWAHATI

After breakfast, transfer to your ship.

**Meals:** breakfast at hotel.

Transfer to ship from airport and explore this pleasant Assami city visiting the Nilachai Hill temple and Commonwealth Graves. Late afternoon cast off upriver.



## DAY 8 SAILING

Sail all day making headway against strong currents through the lush Assami countryside. Get acquainted with your crew and guide with onboard activities such as lectures and food demonstrations.

## DAY 9 TEZPUR

Afternoon exploration of Tezpur by trishaw we visit the De Parbatia temple with its richly carved portals and Cole Park with its collection of medieval carvings collected from across the region.



## DAY 10 NAMERI NATIONAL PARK

After an early breakfast, drive for some two hours to the Nameri National Park at the foot of the blue hills of Arunachal Pradesh, the old North East Frontier Agency. Here, we take a float trip of around two hours down the Jia-Bhoreli River through the park. Enjoy the breath-taking scenery and bring your binoculars for a chance to spot some birdlife. After lunch, take a village walk before returning to the ship. We are treated to a traditional Assamese folk dance before dinner and moor at Silghat for the night.



## DAY 11 KAZIRANGA NATIONAL PARK

Jeep safari to Kaziranga, with an area of approximately 430 sq kms, this UNESCO World Heritage site is home to the world's largest population of the Indian One-Horned Rhinoceros as well as the Indian Wild Water Buffalo. It also has the highest density of Royal Bengal Tigers with one every five sq. km however these remain extremely illusive and are unlikely to be spotted. The park is an incredibly rich biodiversity hotspot with its marshy swamps and thickets of elephant grass which supports large populations of Indian elephants, Indian bison, swamp deer, and capped langurs.



Besides wildlife, Kaziranga National Park is also a birding paradise. A few of the bird species found here are the oriental honey buzzard, black-shouldered kite, white-tailed eagle, Himalayan griffon to mention a few. In the afternoon we set sail again downstream.

# ITINERARY

---



## DAY 12 VILLAGE LIFE

As we sail along the vast Brahmaputra River downstream, riding the strong currents, we stop for a walk through a typical Assamese village and learn more about their simple lives.



## DAY 13 TEA GARDEN & SILK VILLAGE

Early morning visit to Noonmati Tea Garden on the outskirts of Guwahati to witness the tea producing process. After lunch sail down past Guwahati to moor at Sualkuchi, a major centre for weaving in Assam. We learn about the entire silk making production from the cocoon, to spinning and weaving to make the typical saree worn by Assami women.



## DAY 14 ARRIVAL BAGDOGRA

Dock at Guwahati. Following breakfast transfer privately for your flight to Bagdogra. Receive a warm Pandaw welcome on arrival into Bagdogra Airport, and journey by road to your accommodation. Spend the rest of the day easing into your magical surroundings or step outside and stroll the main square and mingle with Nepalese, Bhutanese, Tibetan people and domestic Indian tourists.

**Meals:** Dinner

**Accommodation:** The Elgin Darjeeling / Deluxe Room



## DAY 15 DARJEELING

Darjeeling's rich tapestry of cultures is yours to explore today. Hop aboard the UNESCO World Heritage-listed small-gauge Darjeeling Himalayan Railway, or "Toy Train", for a breathtaking ride to Ghoom, the world's second highest railway station. The toy train is a marvel of engineering passing through many small towns and is India's oldest mountain railway route. Explore Ghoom Monastery, with its colourful prayer flags fluttering in the wind before returning to town.

Continue to the Himalayan Mountaineering Institute, founded in 1954, just after Edmund Hillary and Tenzing Norgay first scaled Everest. Visit the Darjeeling Zoo, home of the Snow Leopard Breeding Centre. Then see locals making handicrafts and carpets at the Tibetan Refugee Centre.

**Meals:** Breakfast & Dinner

**Accommodation:** The Elgin Darjeeling / Deluxe Room

# ITINERARY

---



## DAY 16 DARJEELING TEA ESTATE

Depart early by road, through lush tea gardens to the sublime Glenburn Tea Estate situated on a hillock above the banks of the River Rungeet. Unwind on the the 1,600-acre private estate before an introduction to the specialised art of growing and crafting Glenburn Tea. Visit the tea fields, interact with the tea pickers and follow the journey of “two leaves and bud” into the tea factory, ending with a tea tasting session to discover the incredible variety of flavours and aromas that come from a single bush through the different seasons. Learn why this region is home to almost a quarter of India's tea production.

Enjoy a lunch at the Bungalow followed by a gentle afternoon hike or some down time on one of the peaceful verandas soaking in the views. In the evening take drinks by the bonfire, followed by a sit-down four course dinner with your hosts and other guests in residence.

**Meals:** Breakfast, Lunch & Dinner

**Accommodation:** Glenburn Tea Estate / Suite

## DAY 17 DARJEELING TEA ESTATE

Following a leisurely breakfast, leave the snow-tipped peaks and terraced tea plantations of Darjeeling behind and transfer privately to Bagdogra Airport for your onward journey.

**Meals:** Breakfast



# WHATS INCLUDED & TRANSFERS

---

**Cruise Price Includes:** 1 flight Paro to Guwahati and Bhutan Visa fee. Transfers, hotels and meals off ship as noted. Meals onboard your ship from lunch on embarkation to breakfast before disembarkation, transfer to/from Ship, entrance fees, guide services (English language), gratuities to crew, main meals, local mineral water, jugged coffee, teas & tisanes.

**Cruise Price Excludes:** International flights to Bhutan / out of India, laundry, Indian visa costs, fuel surcharges (see terms and conditions), all beverages except local mineral water, jugged coffee, teas & tisanes, tipping for guide and drivers.

**Note:** We suggest to change money at a bank at the international airport before exiting (currently there is shortage of new money bills in India).

## Transfers & Joining

### DAY 1 ARRIVAL PARO

Arrival to Paro on your own arrangements and transfer to your hotel. Flight arrival is best before midday.

### DAY 14 ARRIVAL BAGDOGRA

Disembark after breakfast and transfer to your hotel or Guwahati airport (15km / 30 min). Transfers can be arranged as per your flight details with the latest departure from the ship at 11am.

# PANDAW STATEROOMS

The Pandaw stateroom is the most celebrated feature of our ships, combining splendid colonial-era character with exquisite contemporary comfort.

Finished in brass and teak, the main and upper deck rooms are a spacious 168 square feet (15.6 sqm), with the exception of the Zawgyi Pandaw which is 150 square feet (14 sqm). As the space is much loved by all our passengers, we have ensured that with each ship we build, the stateroom remains essentially the same. Be advised: our cabins do not have mini-bars, satellite TV's, internet access or telephones. Passengers tend to choose Pandaw in order to escape from the tiresome features found in international business hotels.

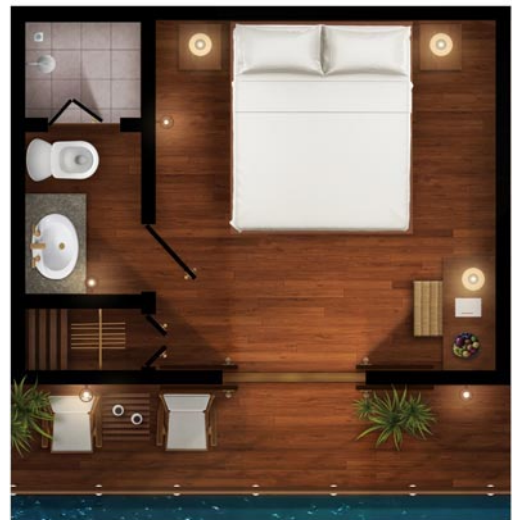

DOUBLE CONFIGURATION

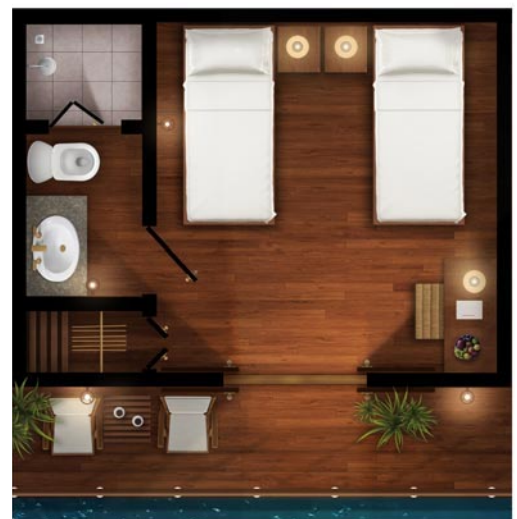

TWIN CONFIGURATION

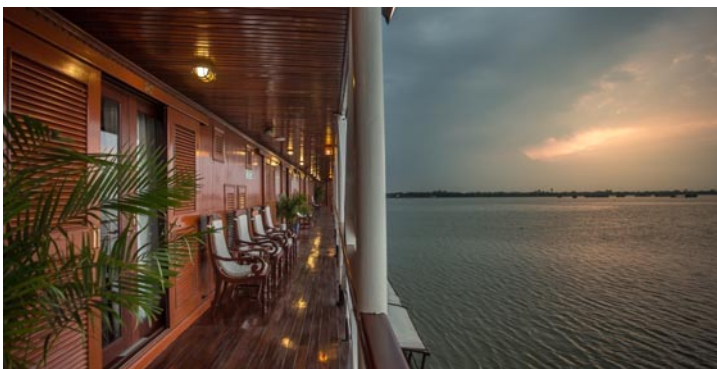

- Fruit and flowers on arrival
- Kimonos and slippers
- Spa-branded amenities
- Unlimited mineral water

Bedroom	12' x 10'
Bathroom	6' x 4'
Showeroom	2' 8" x 3' 4"
Single Bed	6' 7" x 3' 3"

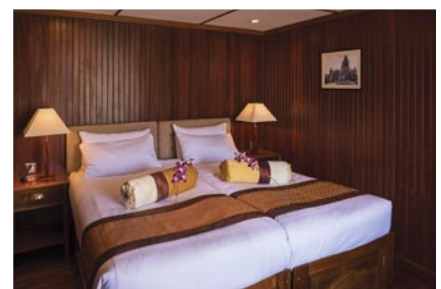
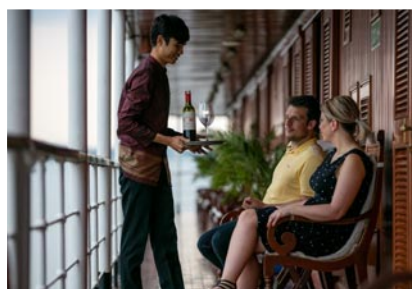

# PANDAW SHIPS

## RV Kindat Pandaw

The original Kindat was built in 1886 by Yarrows in London and sank in 1920. She was named after a small Upper Chindwin town. Following experiments with the Katha and Angkor Pandaws, in this build we perfected this concept of a two deck shallow draft vessel and repeated the formula again with her sister the Kalaw.

What we managed to produce in 2014 was a very shallow draft vessel that could go just about anywhere anytime that was big enough to carry 30-40 passengers with lots of outdoor deck space. We did this by reducing weight and stripping both hull and superstructure down to the bare essentials.

We had found with the experimental Katha that about half our passengers want to eat outside and the other half inside so we created a flexible bistro space offering passenger indoor or outdoor dining depending on inclination, often prompted by the season. This makes for a very happy ship!

The ship has quality mountain bikes for your independent exploration.

[View images of RV Kindat Pandaw](#)

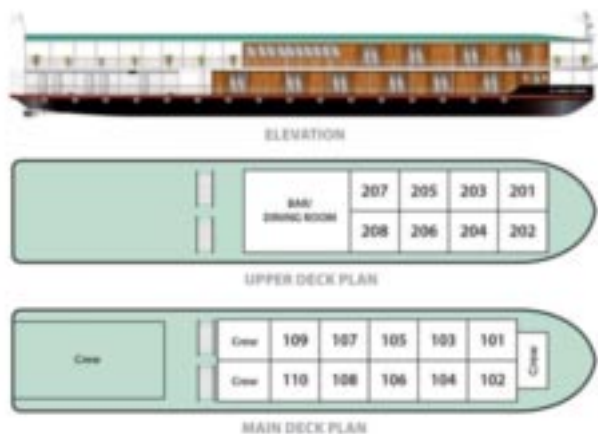

- **Build:** Built in 2014 in Yangon
- **Length:** 187ft / 57m
- **Beam:** 29ft / 8.8m
- **Draft:** 3ft / 90cm
- **Berths:** 36 pax

### ACCOMMODATION

- 8 upper deck staterooms and 10 main deck staterooms
- 170 square feet, finished in teak and brass
- Panoramic French window
- Kimonos and slippers
- Spa-branded amenities
- Unlimited mineral water
- Electric mini safe
- AC with individual control
- Imported quality linens with duvet and two kind of pillows
- Premium mattresses
- Welcome flower arrangement and welcome gift
- Mirror
- Multi-configuration plugs
- Generous closet space and under-bed storage
- Hair dryer
- Nightly turndown service
- 24h laundry service
- Complimentary evening canapés
- Yoga mats in all cabins

### WINING & DINING

- Bistro style dining room with outside seating and air-conditioning inside
- Local master chef heading an experienced international culinary team
- Semi-buffet breakfast, semi-buffet lunch, and seated theme dinners
- Daily lean & light menu options
- Complimentary local mineral water, jugged coffee, teas & tisanes
- Extensive wine list with premium wines
- Series of cultural performances, educational talks, cooking classes, and ship tour
- Welcome drink on arrival
- Welcome cocktail
- Farewell reception
- Theme dinners
- 24hrs hospitality bar
- Onboard bakery with daily freshly baked breads and rolls

### ON EXCURSIONS

- Admissions
- Shoe cleaning after excursions
- Bottled drinking water
- We give away aluminium water bottles
- Cold towel service after excursions
- Refreshing drink following excursions
- 1st aid trained assistant guide to follow all tours and excursions
- Quality mountain bikes available for independent exploration

### SAFETY & SECURITY

- All onboard crew is trained and certified as per international marine standards
- Fire alarm system in all cabins, public areas and back areas
- Firefighting system in all ship areas
- Expert marine superintendant
- 24 hrs watch on duty

### ONBOARD STAFF

- Captain
- River Pilot
- First Officer
- Chief Engineer
- 1st Engineer
- Electrician
- Bosun & nautical crew
- Ship manager
- Housekeeping
- Dining
- Bar keeper
- Chefs
- Local tour guides

### PUBLIC SPACES

- Guest relation desk
- Library with contemporary and classic literature



# PRE CRUISE HOTELS

---



Le Meridien, Thimpu  
[Visit Hotel Website](#)



Dhensa Resort, Punakha  
[Visit Hotel Website](#)



Zhiwaling Heritage, Paro  
[Visit Hotel Website](#)



Radisson Blu Guwahati  
[Visit Hotel Website](#)

# POST CRUISE HOTELS

---



The Elgin Darjeeling

[Visit Hotel Website](#)



Glenburn Tea Estate

[Visit Hotel Website](#)

# OPTIONAL PACKAGE ADDONS & OTHER INFORMATION

---

**Optional cruise add ons** NOTE: Only available on the cruise section

**PRE-BOOKABLE HOUSE WINE PACKAGE INDIA** CLICK [HERE](#) TO FIND OUT MORE

**FREE FLOW DRINKS INDIA** CLICK [HERE](#) TO FIND OUT MORE

**FREE FLOW DRINKS & WINE PACKAGE INDIA** CLICK [HERE](#) TO FIND OUT MORE

---

## River Conditions Warning!

The rivers you will sail on are subject to seasonal rises and falls of water level, in some places as much as 30 metres. Water levels can change dramatically overnight and a sudden rise can impede our progress upstream considerably and even prevent us from passing under certain bridges. A sudden fall can result in our being unable to get into certain places or go as far upstream as we would hope. Groundings on sandbars are not infrequent and are part of the excitement of any Pandaw expedition. Published itineraries are indicational only and subject to sudden change. In such events alternative itineraries will be provided and we do our best to ensure that if a stop is missed we make up for it with another stop. Passengers are thus forewarned and expected to be flexible and patient. River cruising in Asia can be a dramatic and adventurous experience - not like cruising the controlled waterways of Europe or America. Note also that we operate in areas with little or no developed infrastructure and subject to the strictures of local officialdom. Be prepared for this and it is all more the fun!

---

## Useful Links

**BOOKING TERMS & CONDITIONS** CLICK [HERE](#) TO FIND OUT MORE

**GENERAL INFORMATION & LIFE ON BOARD** CLICK [HERE](#) TO FIND OUT MORE

**VISA INFORMATION** CLICK [HERE](#) TO FIND OUT MORE



FOLLOW US ON SOCIAL MEDIA

 facebook.com/pandawriverexpeditions

 @pandaw\_river\_expeditions

 @pandaw-river-expeditions

 Pandaw Expeditions

 PANDAW

**UK**

 FREEPHONE 0800 038 1029

 uk@pandaw.com

**GLOBAL**

 +84 (0)28 4458 2618

 information@pandaw.com

**NORTH AMERICA**

 TOLL FREE 1-877-872-6329

 usa@pandaw.com

**AUSTRALIA**

 TOLL FREE 1800 207 625

 aus@pandaw.com

**NEW ZEALAND**

 TOLL FREE 0800 115 250

 aus@pandaw.com

**GERMANY, SWITZERLAND  
& AUSTRIA**

 +49 30 3464981 30

 dach@pandaw.com

PANDAW.COM